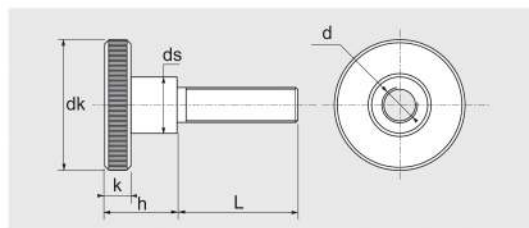

Inox A1

62 235
DIN 464

VIS MOLETEES TYPE HAUT

KNURLED THUMB SCREWS HIGH TYPE
RÄNDELSCHRAUBEN HOHE FORM
TORNILLOS MOLETEADOS FORMA ALTA

d	M 3	M 4	M 5	M 6	M 8
dk	12	16	20	24	30
k	2,5	3,5	4	5	6
ds	6	8	10	12	16
h	7,5	9,5	11,5	15	18
Pas	0,5	0,7	0,8	1	1,25

d x L	Code	Cond.	kg/100
3X4	622353X4	50	0,350
3X5	622353X5	50	0,354
3X6	622353X6	50	0,359
3X8	622353X8	50	0,368
3X10	622353X10	50	0,377
3X12	622353X12	50	0,386
3X16	622353X16	50	0,420
3X20	622353X20	50	0,452
4X5	622354X5	50	0,828
4X6	622354X6	50	0,836
4X8	622354X8	50	0,851
4X10	622354X10	50	0,866
4X12	622354X12	50	0,881
4X16	622354X16	50	0,910
4X20	622354X20	50	0,958
4X25	622354X25	50	1,010
5X6	622355X6	25	1,520

d x L	Code	Cond.	kg/100
5X8	622355X8	25	1,540
5X10	622355X10	25	1,570
5X12	622355X12	25	1,600
5X16	622355X16	25	1,670
5X20	622355X20	25	1,730
5X25	622355X25	25	1,870
6X10	622356X10	25	2,840
6X12	622356X12	25	2,870
6X16	622356X16	25	2,930
6X20	622356X20	25	3,000
6X25	622356X25	25	3,080
6X30	622356X30	25	3,150
8X16	622358X16	10	5,680
8X20	622358X20	10	5,800
8X25	622358X25	10	5,920
8X30	622358X30	10	6,000