

Inox A4**64610**
Hh - UNI 5587**ECROUS HAUTS, m = d**

HEXAGON HEAVY NUTS, m = d

SECHSKANTMUTTERN HÖHE FORM, m = d

TUERCAS HEXAGONALES, m = d

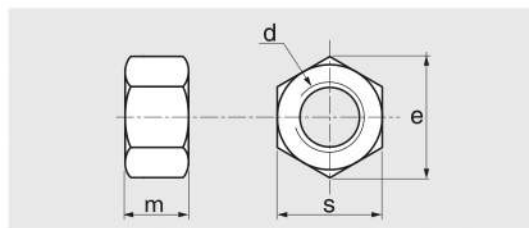

d nominal	Code	Pas	e	m	s	Cond.	kg/100
M 3	646103	0,5	6,08	3	5,5	200	0,058
M 4	646104	0,7	7,74	4	7	200	0,114
M 5	646105	0,8	8,87	5	8	200	0,166
M 6	646106	1	11,05	6	10	200	0,320
M 8	646108	1,25	14,38	8	13	200	0,640
M 10	6461010	1,5	18,9	10	17	100	1,440
M 12	6461012	1,75	21,1	12	19	100	2,080
M 14	6461014	2	24,49	14	22	50	3,180
M 16	6461016	2	26,75	16	24	50	4,100
M 18	6461018	2,5	30,14	18	27	50	5,920
M 20	6461020	2,5	33,53	20	30	25	8,040
M 24	6461024	3	39,98	24	36	25	13,900
M 27	6461027	3	45,63	27	41	10	20,460
M 30	6461030	3,5	51,28	30	46	10	27,650
M 33	6461033	3,5	55,8	33	50	10	35,710
M 36	6461036	4	61,31	36	55	10	48,730